

# HOW TO

---

## RE-FILL

1. The fill valve is located in the center of the black adjustment valve.

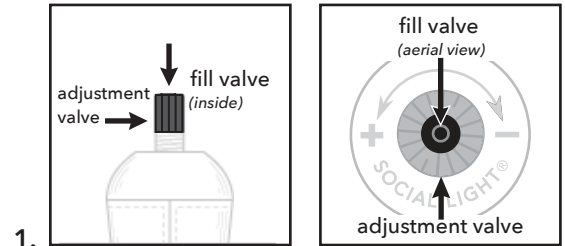

2. Hold the lighter with the flame end down, perpendicular to the ground.

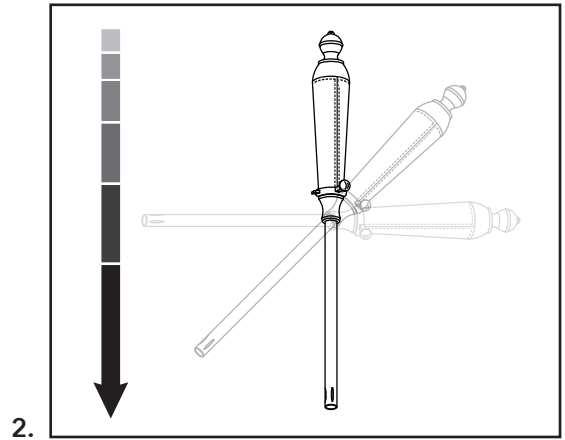

3. Completely insert the nozzle of the Butane re-fill can into the fill valve and hold steady for 4-5 seconds.

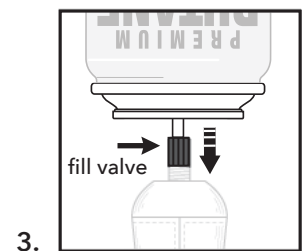

4. Repeat step 3. You have now successfully re-filled your lighter.\*

*\*Depending on usage, you will get approximately 200 lights per filling.*

